

Spacious & Stylish
4 bedroom living
at its most affordable

Delta 22 \$239,900*



metricon

FREEDOM

m
metricon

*Feature
timber
panelling*



*Price based on Delta 22 with Peak façade on new deposits from 01.10.23 for a limited time. Valid only in SA Metro build region (as defined on www.metricon.com.au/services/where-we-build#SA). Not valid with any other offer. Price excludes land and site costs. Site costs are site specific and will vary according to your land. Image contains items not provided by Metricon and are not included in the price namely driveway, fencing and landscaping. Image includes upgrade items not included in the price namely external lighting and tiled portico. For full details including a full list of standard inclusions, please speak to a New Home Advisor. SA Builder's Licence BLD231776.

Delta 22 with Peak façade now from \$239,900*

If you're looking for a 4-bedroom home at an affordable price look no further than the Delta 22 with Peak façade. With four bedrooms, 2 bathrooms, 2 living areas and a double car garage, it's perfect for growing families.

The Delta's intelligent design sees all four bedrooms located on one side of the home providing an open plan layout with living areas on the other. The integrated kitchen, dining and family rooms provide a focal point for family living. And now the Delta 22 with Peak façade could be yours from \$239,900*. This offer is for a strictly limited time.

GET THE DELTA 22 FROM
\$239,900*

DELTA 22

4 | 2 | 2 | 2

Standard floorplan and specification show.

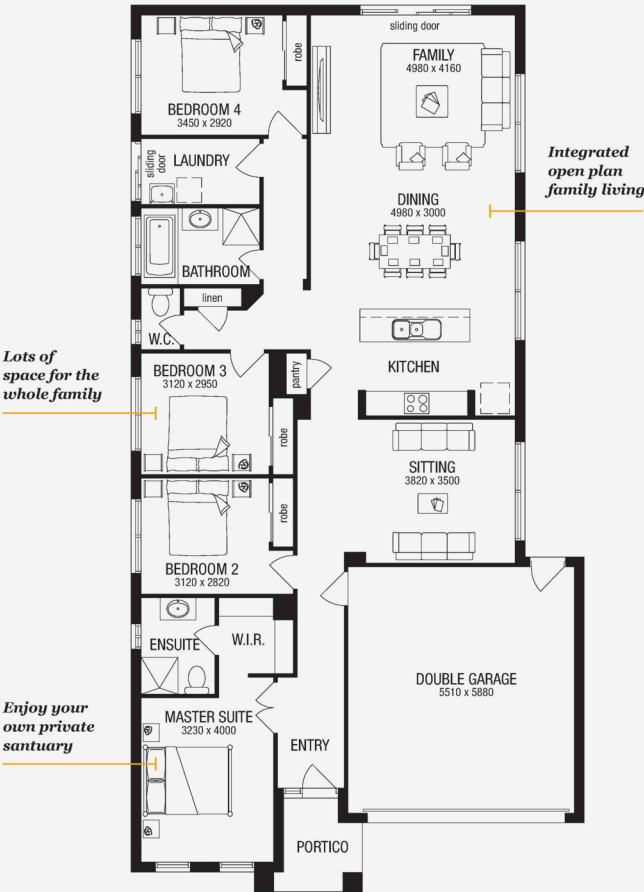

Home Area	167.54m ²
Garage Area	36.37m ²
Portico Area [^]	4.36m ²
Total Area	208.27m²
Home Width	11.03m
Home Length	21.59m
Min Block Width	12.5m

THE METRICON DIFFERENCE

IT'S WHAT MAKES METRICON AUSTRALIA'S MOST LOVED BUILDER



We've been helping Australians love where they live for more than 45 years. Whether you're building your first home or your forever home, we're with you every step of the way – from the first brick to final handover.



Our homes are designed to celebrate you. This is why we continually strive to create innovative, award-winning designs that help you make the most of your home and the life you live in it.



Our homes may have changed over the years but our commitment to excellence hasn't. Our rigorous quality assurance process ensures every Metricon home is built to the highest standard.



Every Metricon home is backed by a Lifetime Structural Guarantee*, so you can build with the confidence and peace of mind that it will stand the test of time.



We believe no one else designs and builds as well as us and, as Australia's No.1 home builder^ for the seventh year running, we must be doing something right. That's why more people choose to build with Metricon, Australia's most loved home builder.

metricon

metricon.com.au | 1300 001 289

*The Guarantee applies to all new home building contracts signed after 1 January 2019 and is subject to the terms and conditions of the Guarantee which can be found at metricon.com.au/terms-conditions. ^HIA-Colorbond® Steel Top 100 Report 2016/17/18/19/20/21/22.