

Four bedroom, big family living

Mantra 33A

\$344,900*
after discount.



metricon

FREEDOM



ON DISPLAY
AT RIVERLEA, RIVERLEA PARK[^]

*Price based on Mantra 33A with Yale façade on new deposits from 01.07.23 for a limited time. Valid only in SA Metro build region (as defined on www.metricon.com.au/services/where-we-build#SA). Not valid with any other offer. Price excludes land and site costs. Site costs are site specific and will vary according to your land. Image contains items not provided by Metricon and are not included in the price namely driveway, decking, fencing and landscaping. Image includes upgrade items not included in the price namely entrance door, render and external lighting. [^]As displayed price differs from promotional price. Displayed home features upgrade items that are available at additional cost. SA Builder's Licence BLD231776.

Mantra 33A with Yale façade now from \$344,900*

The new Mantra 33A is a home with room for the whole family. With four bedrooms, two spacious living rooms, two bathrooms and a separate powder room, this light filled home is one to delight. The master suite is situated at the back of the home for privacy and features an ensuite and walk-in-robe while the three additional bedrooms are grouped at the front of the house with additional leisure room to create a kids' retreat and flexible family living. The well-designed central kitchen opens up to the family and dining rooms while a large outdoor room and sitting room create flexible family living.

GET THE MANTRA 33A FROM
\$344,900*
AFTER DISCOUNT

MANTRA 33A

4 | 2 | 3 | 2

Standard floorplan and specification show.

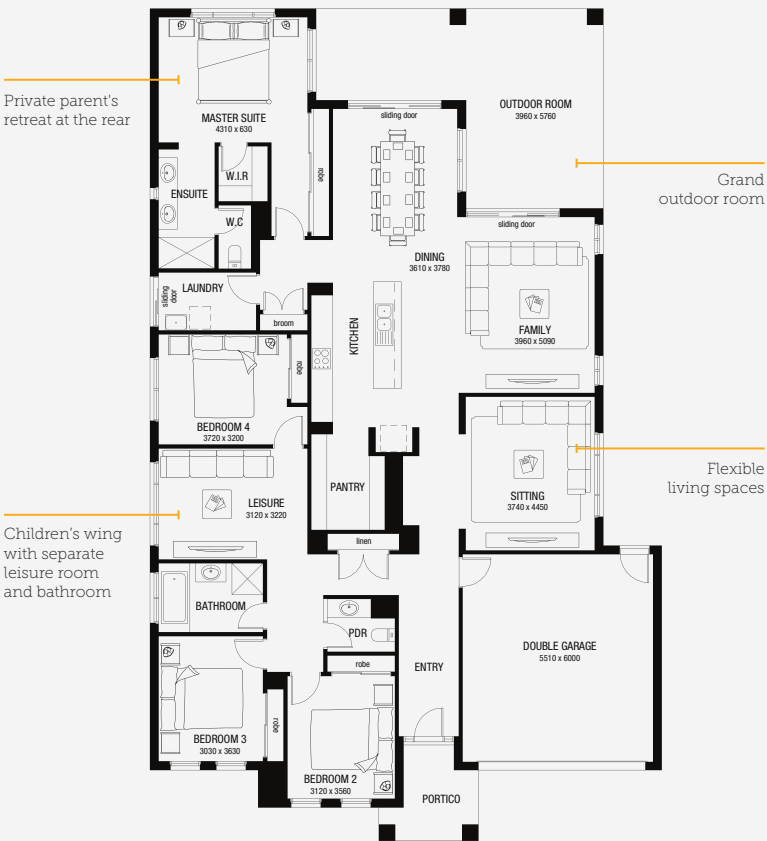

| | |
|------------------------|----------------------------|
| Home Area | 230.62m ² |
| Garage Area | 36.4m ² |
| Portico Area* | 6.13m ² |
| Total Area | 307.37m² |
| Home Width | 14.75m |
| Home Length | 23.99m |
| Min Block Width | 16m |

THE METRICON DIFFERENCE

IT'S WHAT MAKES METRICON AUSTRALIA'S MOST LOVED BUILDER



We've been helping Australians love where they live for more than 45 years. Whether you're building your first home or your forever home, we're with you every step of the way – from the first brick to final handover.



Our homes are designed to celebrate you. This is why we continually strive to create innovative, award-winning designs that help you make the most of your home and the life you live in it.



Our homes may have changed over the years but our commitment to excellence hasn't. Our rigorous quality assurance process ensures every Metricon home is built to the highest standard.



Every Metricon home is backed by a Lifetime Structural Guarantee*, so you can build with the confidence and peace of mind that it will stand the test of time.



We believe no one else designs and builds as well as us and, as Australia's No.1 home builder^ for the seventh year running, we must be doing something right. That's why more people choose to build with Metricon, Australia's most loved home builder.

metricon

metricon.com.au | 1300 001 289

*The Guarantee applies to all new home building contracts signed after 1 January 2019 and is subject to the terms and conditions of the Guarantee which can be found at metricon.com.au/terms-conditions. ^HIA-Colorbond® Steel Top 100 Report 2016/17/18/19/20/21/22.